

Quiz Rally

Kyuhaku New Year Tour



CATCH THE DRAGON 2024
1 January (Mon) - 4 February (Sun)

Cultural Exchange
Exhibition Hall (4F)

Think of a dragon - what comes to mind? The mythical dragon is one of the 12 animals in the Chinese zodiac. To celebrate the Year of the Dragon, 2024, we are displaying works featuring dragon motifs. Look for all the dragons you can find - if you answer the quiz rally questions on the back of this paper, you may just win a prize!

How to join

1. Fill out your personal information on the back side of this paper
2. Take the quiz as you go around our Cultural Exchange Exhibition Hall (4F)
3. After answering all the questions, bring this answer sheet to the cash register at the **Kyuhaku Museum Shop (1F)**!



The Quiz Rally symbol!



Correctly answer all 4 questions to enter a lucky draw to win a prize!

First 50 participants each day will receive an Original Kyuhaku Metal Badge!

As prizes are limited to one per person, please note the Museum Shop will accept only one answer sheet per person.

5 types of Badges!
* You cannot choose the type of badge you will receive
* Badges are given on a first-come, first-served basis. Please understand that we may run out.

Quiz Rally Prizes

- Prize A** **Kyushu National Museum Restaurant linoji** **3** meal coupon sets for **6** people
- Our new restaurant just opened last December!
Choose between Kyushu Kuroge Wagyu Sukiyaki and Hot-stone Unagi Hitsumabushi dishes!
- Prize B** **Kyushu National Museum M Café** **5** meal coupon sets for **10** people
- Why not stop and take a break at our café?
Choose one of your favourite desserts and drinks from our selection.
- Prize C** **Assorted Kyuhaku Goods** **10** people
- This assortment includes popular items from our Museum Shop!



Fill out the information below to take part in the Quiz Rally!

Katakana Name	Age	Telephone Number ()
Address 〒 -		

Please fill in a Japanese mailing address and phone number, as prizes can only be distributed within Japan. Thank you!

To answer these questions,
look around the museum for
dragons!

* (Circle ① ② or ③ to answer)



Q1

Where are the dragons on this National Treasure, a bronze bell?

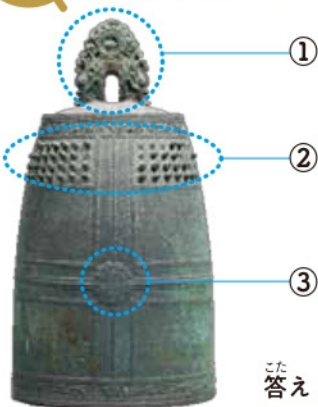

HINT
It's in Theme 3: Nation Building: The Age of the Envoys!

答え ① ② ③

Q2

This lusterware tile depicts a dragon. What country was it excavated from?



- ① Thailand
- ② Iran
- ③ India

HINT
It's in Room 8!

答え ① ② ③

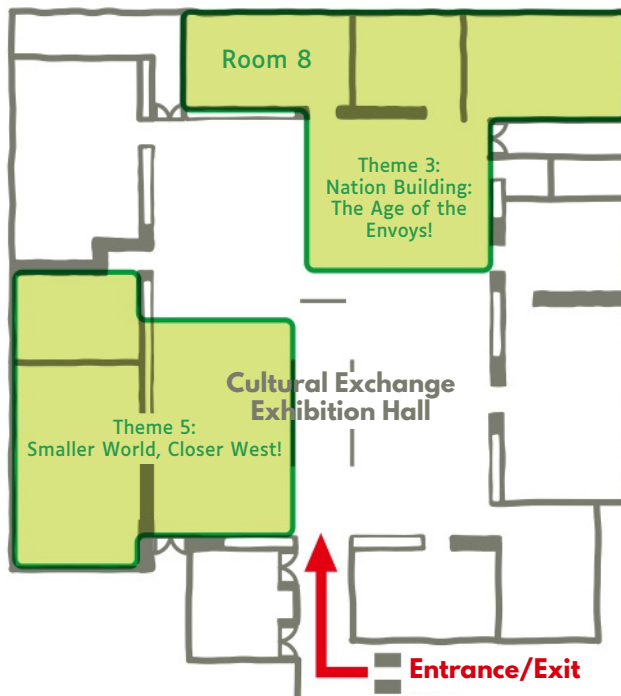

Q3

What color is the face of the dragon in the center of this enameled bowl?



- ① Blue ② Red ③ Gold

HINT
It's in Theme 5: Smaller World, Closer West!

答え ① ② ③

Q4

How many cards are in this Edo-period card game, *Unsun Karuta*?

- ① 48
- ② 52
- ③ 75

HINT
They're in Theme 5: Smaller World, Closer West!

答え ① ② ③



After answering all the questions, bring this answer sheet to the **1F Museum Shop** cash register!